

ANNASTAR

The Westport 164 with a completely customised interior

**FAMILY GUY**

The owner's child-friendly boat that's also a high-tech office

**SAN FRANCISCO**

Explore California's finest during the America's Cup finals



BOAT

INTERNATIONAL

ZENSATIONAL

The cool, contemporary, Asia-influenced glamour of Benetti's 55m *Ocean Paradise*

SMOOTH OPERATOR

On board Rossinavi's 48m *Ketos*, where distinctive styling meets a comfortable cruising interior

MONACO SHOW PREVIEW

We pick 24 of the best new yachts at this year's show – turn to page 48



Ketos

words: Roberto Franzoni
photography: Alberto Cocchi





THE KETOS 48M MARKS
ROSSINAVI'S ENTRY INTO
THE PRODUCTION YACHT
MARKET, YET SHE REMAINS
A BOAT DESIGNED AROUND
THE OWNER'S WISHES

After launches of **Aslec IV** and **2 Ladies** in 2012, this year it is the turn of the Ketos 48m: the seventh yacht to be launched by Rossinavi, and the first in a new range created by the yard in collaboration with naval architect Enrico Gobbi and Team 4 Design Venice.

The Ketos range is a new step for the yard, which has to date only built custom yachts designed by their clients' architects. The Ketos story began a few years ago at a meeting between Gobbi and the Rossi family about the construction of an aluminium 40 metre planing yacht. 'From this first experience came the 2009 collaboration with Team 4 Design, and now we have now developed the Ketos range together,' says Claudia

Rossi, Rossinavi's head of marketing. 'The project immediately appealed to us, with its original windows and sleek, sporty lines. We offered it to the market and the owner of the 40 metre planing yacht was fascinated by it.'

The name Ketos has a rich maritime history, evoking strength and power. In Greek mythology 'ketos' were large, powerful and aggressive fish or whales, such as the one that swallowed Jonah in the biblical tale. And their Latin name – **cetus** – was given to ships that were capable of tackling any weather condition.

Rossinavi's modern day **cete** come in three models: the original 43 metre concept with two-and-a-half decks, and tri-deck 53 metre and a 70 metre versions. The Ketos range's distinctive feature are dynamic, powerful, sleek lines that create a brave, modern look.

The first Ketos promoted by the yard and the designer was the 43 metre model. But even if 'small is beautiful' with boats, owners always feel they are at least a metre short. The first client to be enchanted by the Ketos was the owner of a 40 metre planing yacht, but he was not satisfied with 43 metres and wanted to add another five; the Ketos 48m was born.

While this model remains the smallest of Rossinavi's range, its growth did not distort the characteristics of Gobbi's distinctive design; rather it enhanced them.

The vertical windows in the bow (left) flood the owner's cabin and main deck with light. The upper deck's roof, windows and doors may be opened, creating an Open-style deck area



While this model remains the smallest of Rossinavi's range, its five metre growth did not distort the characteristics of Gobbi's distinctive design; rather it enhanced them





'We wanted the Ketos line to include stylistic markers that would highlight the advanced, powerful and dynamic lines, without being aggressive,' explains Gobbi. 'We also wanted to ensure the markers and lines would maintain a sleek profile that would express vitality and show a strong personality; lines recognisable from the first glance.'

With the Ketos 48m, Gobbi and Team 4 Design have created a striking and original composition of openings and windows – in particular the four vertical strips in the wide bow area that hosts the owner's suite. 'From the outside the vertical strips look like large air intakes, but they are signs related to force,' says Gobbi. 'To these we added features to enhance the aerodynamic lines: horizontal windows in the hull that are long and slender, and aligned parallel to the waterline, which illuminate the guest cabins on the lower deck. These elongate the hull, don't break the continuity, and add light to the guest cabins while also offering a view.'

Ketos 48m is defined as a two-and-a-half deck due to its low lines. It is practically a sporty Open, but in reality is a comfortable tri-deck. One of its best features is the upper deck, rarely seen in this type of yacht or in these dimensions. This deck hosts the bridge and helm to the bow, and features a large dining area, lounge area, bar, large area with sunbeds and, even more surprisingly, a circular spa pool in the middle of the glass wall that separates the interior from the aft upper deck.

A two-part circular door slides around the spa pool, allowing it to become part of the aft deck or the interior; leaving the door open creates a continuous space along the length of the deck. These doors also allow passage between the covered and uncovered parts of the upper deck. 'We had already studied this solution for the

Ketos 48m is defined as a two-and-a-half deck due to its low lines. It is practically a sporty Open, but in reality it is a comfortable tri-deck

Ketos 48m's owner likes classical styling. While he admired Ketos' extremely modern lines for the exterior, he wanted a traditional style for the interior

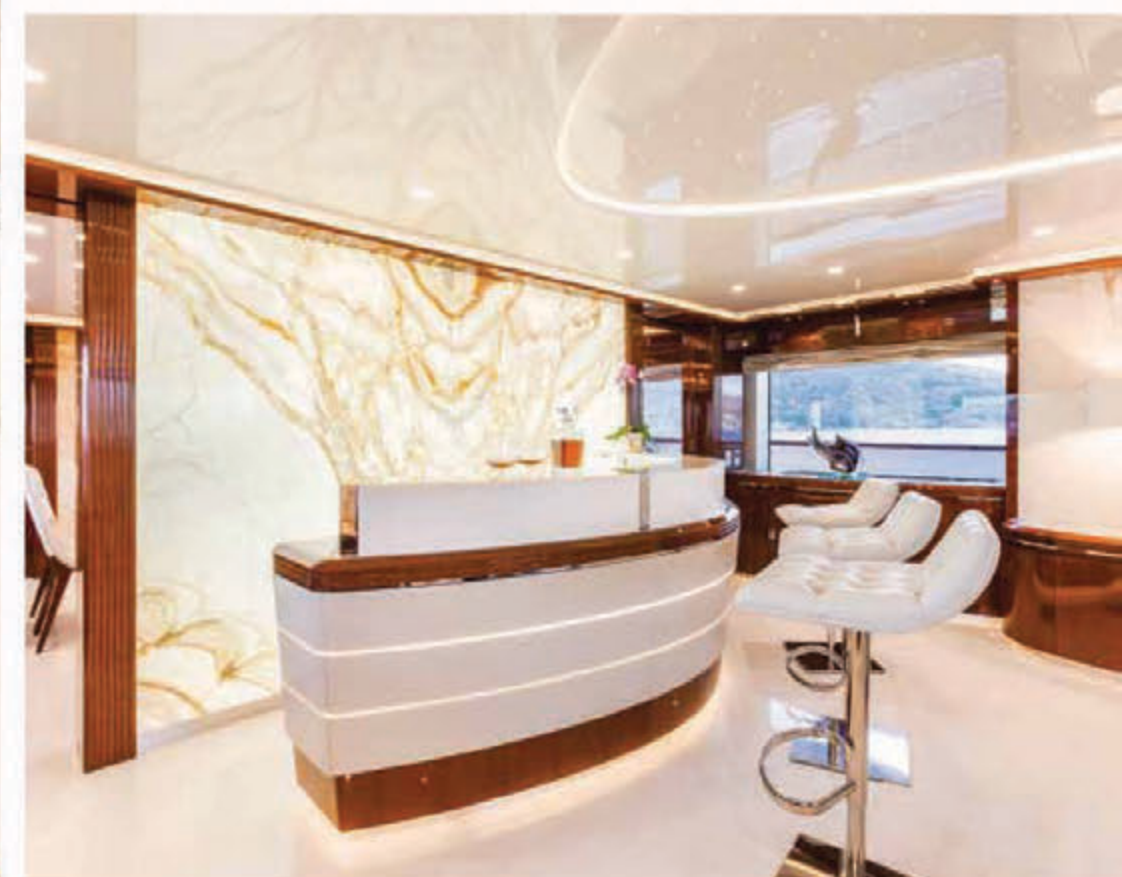

Naval architect Monica Morati and Team 4 Design used dark cherry wood in the Ketos 48m's interior for traditional highlights, with cream material and backlight onyx for large panels to lighten the interiors. Enrico Gobbi says the yacht becomes a 'fountain of light' at night (left)

owner of the 40 metre planing yacht,' remembers Gobbi, 'and he found it so satisfactory that he also wanted it aboard the Ketos 48m – but bigger.

'Thanks to the technical resources of the Rossinavi yard, we were able to create an electrical control to open the upper deck's four windows, just like in a car, and to make part of the roof slide back. This is a considerable feat of engineering, as the windows are more than two metres long and made of very thick, heavy glass.

'To highlight the internal/external relationship and offer continuity we made all of the deck, inside and outside, from teak. Ketos 48m is not an open-decked yacht, but on this level, when the circular doors and the

roof are opened and the windows are down, it is just like being on board one.'

The owner likes classical styling. While he admired her extremely modern lines for the exterior, he wanted a traditional style for the interior, featuring materials he had used aboard his previous yachts. Gobbi, while respecting his wishes, steered him towards classic-modern, timeless solutions using materials chosen by the owner and his wife, who played a role in the choice of details and colour.

'We started with high-gloss cherry, as this was the first and non-negotiable request,' said Gobbi. 'To match an interior with classic accents to such modern external lines we used a scheme combining cherry with large, light





surfaces, creating a contrast in which the wood became the marker of the horizontal and vertical planes – the framework, profile and planking – but was not used for large and heavy panels. We also agreed on the application of highly decorative stones, such as onyx, which were also backlit, and convinced the owner to use mainly straight lines with a few curves in the saloon, so as not to create too violent a contrast between the exterior and interior.’

The interior layout is based around the semi-wide body of the main deck. The owner’s suite is situated in the bow and benefits from the tremendous light and spectacular views seen through those vertical, angled windows. They flood the suite, and the deck above it, with sunlight from the sides of the hull. On the main deck are the dining area, galley, main saloon and lobby, as is traditional. A spiral staircase in the lobby is decorated with an extraordinary lamp consisting of a series of steel circles studded with Swarovski crystals, which diffuse the LED light hidden behind them to create a stellar effect.

‘We designed this lamp which extends over two decks in the staircase,’ says Gobbi. ‘The Swarovski office in New York carried out the engineering work to ensure the lighting design was correct and that its power needs would be met. Light is a fundamental element of this project. We have always opted for indirect light as it allows extraordinary effects to be created when it is dimmed. To break up the surfaces we have used light as a material, a moulding, to cut surfaces that are too large horizontally and vertically. Seen by night, Ketos 48m is a fountain, in which light cascades from all the openings towards the sea.’

On the lower deck is a large full-beam VIP suite and two guest cabins, one with twin beds, and the other with a king-sized bed. ‘In the owner’s and guest bathrooms we used afyon white marble, but we used golden mosaic in the lady owner’s bathroom,’ explains Monica Morati, the in-house architect who created the interior with Team 4 Design. ‘In the saloon we added sheets of honey onyx to the panels and a large sheet of white onyx, backlit to highlight its unusual veins, in the partition separating the dining area – all personally chosen by the lady owner.

‘The free-standing furniture is split between pieces made by artisans working to plans by Team 4 Design, and production furniture with personalised finishes and upholstery,’ Morati continues. ‘Another characteristic of the yacht are its bars. There are three: one on the upper deck, one in the main deck’s sundeck and another in the saloon. You will not die of thirst aboard!’

‘In the engine room are two MTU 16V 2000 M94 engines of 2,600hp,’ concludes Rossi, ‘chosen for cruising in maximum comfort rather than moving at high speeds – 17.5 knots is the boat’s top speed. The Humphree interceptor was used to guarantee the best trim.’

Ketos 48m is classified as RINA Pleasure Craft, as the owner is a passionate navigator who wants to use the yacht personally and has already clocked thousands of miles. She is also MCA-compliant, ensuring that when her owner would like to sell, the new owner will have no problems chartering the yacht if they wish. And there is no doubt that she would be snapped up quickly.



The full-beam owners’ cabin (above) and bathrooms (opposite left) and the dramatic stairwell with its steel and crystal lamp (left), reflect the mixture of classical yacht styling and the creative use of light that mark out the Ketos 48m’s interior design



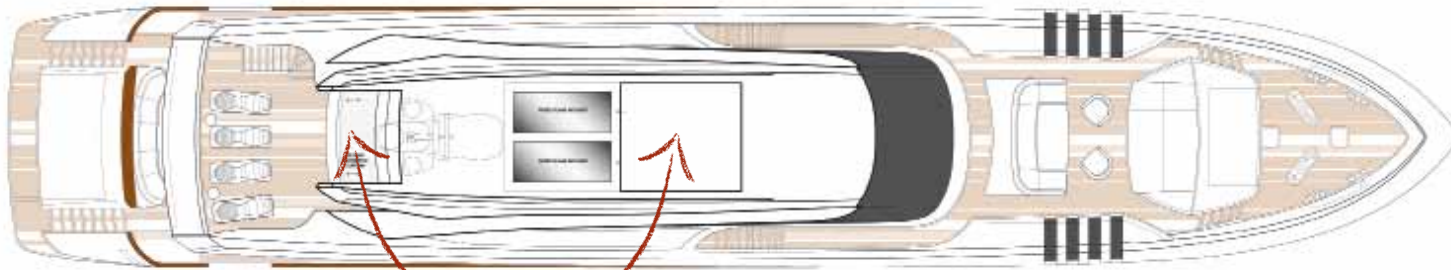

An aft curtain and aluminium roof retract, turning the closed upper deck into an open one

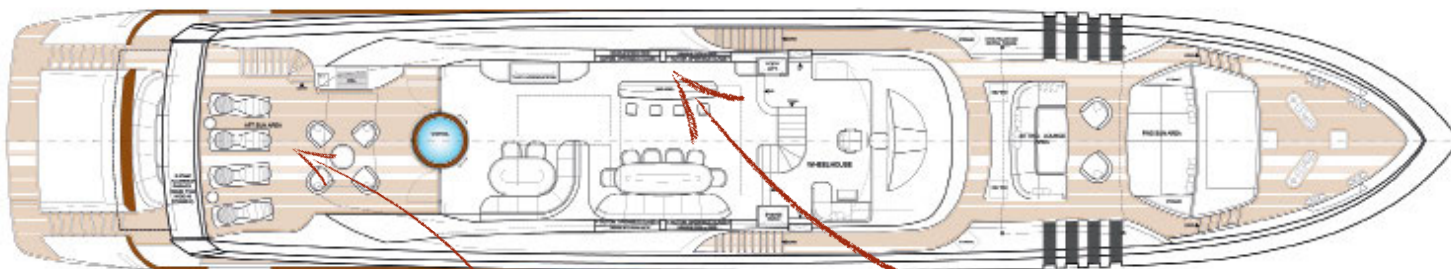

The sundeck area may be opened by raising windows and opening its roof

Windows of the upper deck's bar open fully, using electrical controls

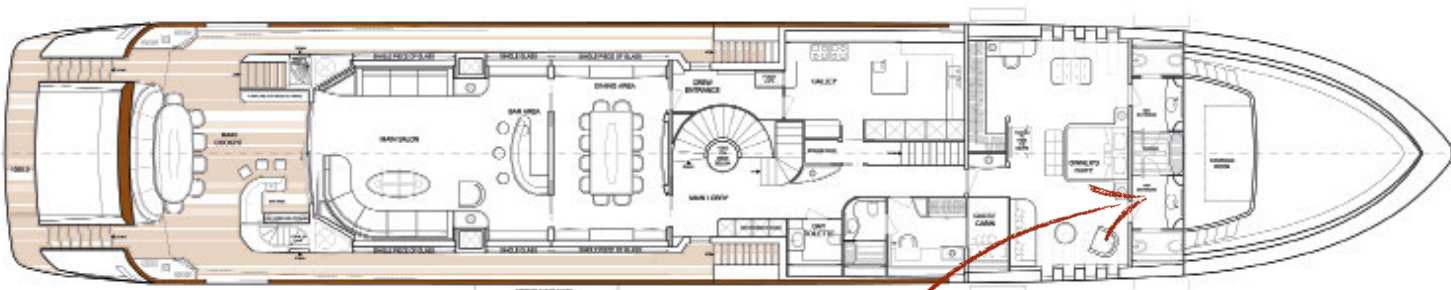

A large tender is stowed athwartships, adjacent to the beach club

The full-beam owners' suite features his and her en suites

VIP and guest cabins are located around the central stairwell

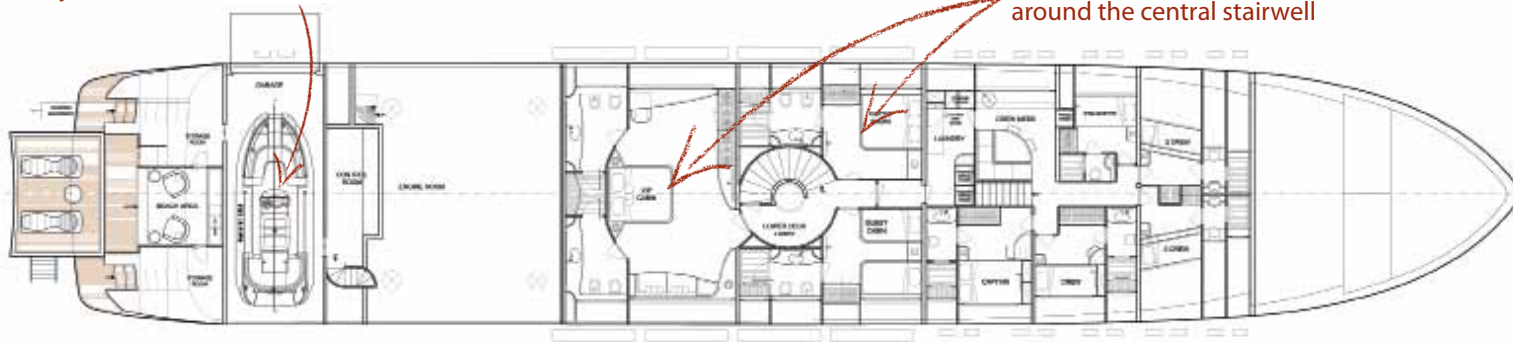

KETOS 48M *Rossinavi*



<p>LOA 47.5m LWL 38m Beam 8.8m Draught 2.3m Displacement 248 tonnes Gross tonnage 500GT</p>	<p>Engines 2 x MTU 16V 2000 M94, 2,600hp Speed (max/cruise) 17.5 knots/15.5 knots Range at 10 knots 2,500nm Thrusters 1 x 75kW bow; 1 x 37kW stern</p>	<p>Generator CAT C6.6, 143ekW Fuel capacity 25,000 litres Freshwater capacity 6,500 litres Owner and guests 9 Crew 7</p>	<p>Tender Castoldi 21 6.3m Construction Aluminium Classification RINA Pleasure Craft, Maritime and Coastguard Agency compliant</p>	<p>Naval architecture Arrabito Naval Architects Interior and exterior design Enrico Gobbi; Team 4 Design Venice</p>	<p>Builder/year Rossinavi/2013 Viareggio, Italy t: + 39 584 384 227 e: commerciale@rossinavi.it w: rossinavi.it</p>
---	--	--	--	---	---